

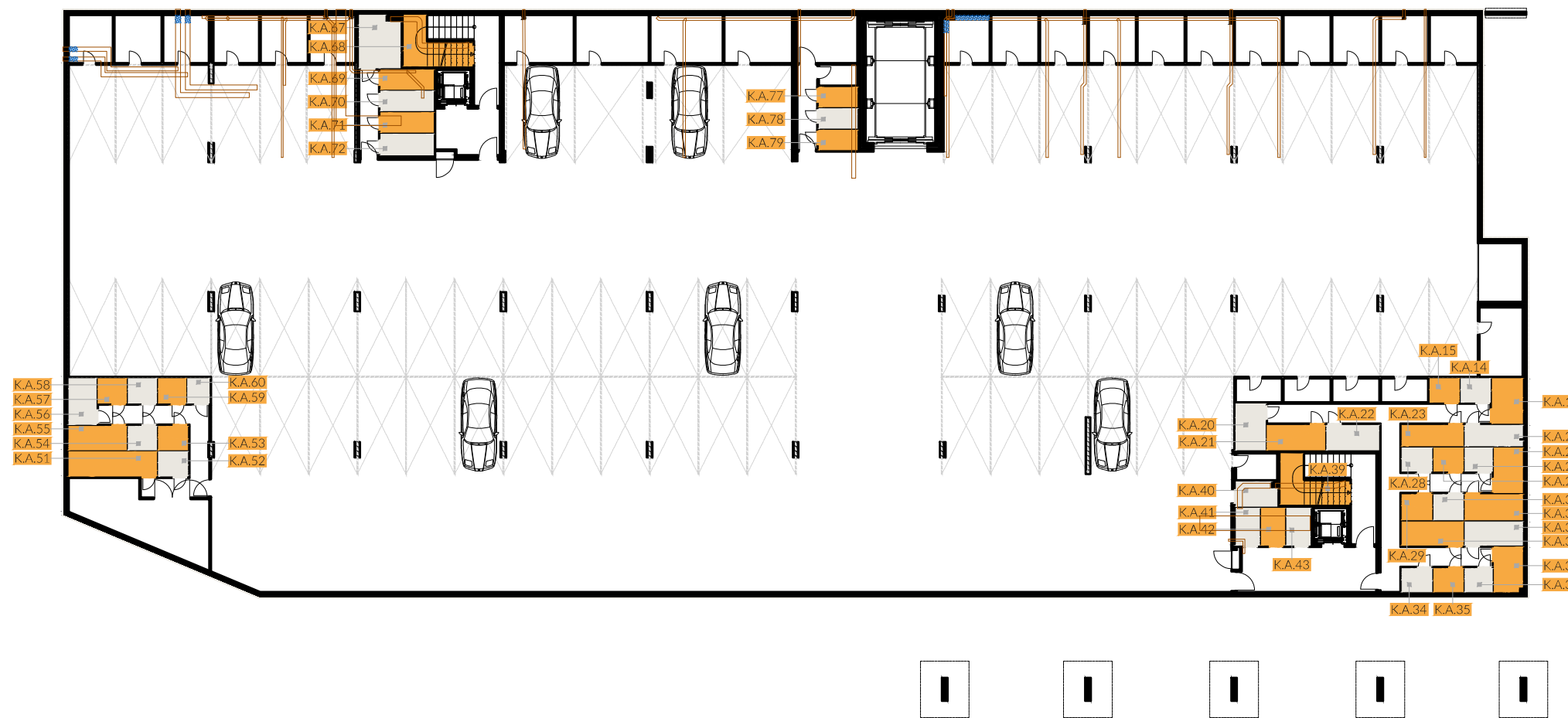



# PODZEMNÉ PODLAŽIE / B A S E M E N T BLOK A

k o b k y / c e l l s

K.A.13 kobka / cell	3,64m <sup>2</sup>	K.A.41 kobka / cell	2,26m <sup>2</sup>
K.A.14 kobka / cell	1,87m <sup>2</sup>	K.A.42 kobka / cell	2,35m <sup>2</sup>
K.A.15 kobka / cell	1,87m <sup>2</sup>	K.A.43 kobka / cell	2,35m <sup>2</sup>
K.A.20 kobka / cell	3,59m <sup>2</sup>	K.A.51 kobka / cell	5,69m <sup>2</sup>
K.A.21 kobka / cell	3,76m <sup>2</sup>	K.A.52 kobka / cell	1,94m <sup>2</sup>
K.A.22 kobka / cell	3,41m <sup>2</sup>	K.A.53 kobka / cell	1,87m <sup>2</sup>
K.A.23 kobka / cell	3,36m <sup>2</sup>	K.A.54 kobka / cell	1,81m <sup>2</sup>
K.A.24 kobka / cell	3,17m <sup>2</sup>	K.A.55 kobka / cell	3,61m <sup>2</sup>
K.A.25 kobka / cell	3,40m <sup>2</sup>	K.A.56 kobka / cell	3,36m <sup>2</sup>
K.A.26 kobka / cell	1,75m <sup>2</sup>	K.A.57 kobka / cell	1,88m <sup>2</sup>
K.A.27 kobka / cell	1,87m <sup>2</sup>	K.A.58 kobka / cell	1,88m <sup>2</sup>
K.A.28 kobka / cell	1,91m <sup>2</sup>	K.A.59 kobka / cell	1,82m <sup>2</sup>
K.A.29 kobka / cell	2,06m <sup>2</sup>	K.A.60 kobka / cell	1,45m <sup>2</sup>
K.A.30 kobka / cell	2,02m <sup>2</sup>	K.A.67 kobka / cell	5,71m <sup>2</sup>
K.A.31 kobka / cell	3,91m <sup>2</sup>	K.A.68 kobka / cell	5,83m <sup>2</sup>
K.A.32 kobka / cell	3,61m <sup>2</sup>	K.A.69 kobka / cell	2,76m <sup>2</sup>
K.A.33 kobka / cell	3,83m <sup>2</sup>	K.A.70 kobka / cell	2,76m <sup>2</sup>
K.A.34 kobka / cell	1,91m <sup>2</sup>	K.A.71 kobka / cell	2,76m <sup>2</sup>
K.A.35 kobka / cell	1,87m <sup>2</sup>	K.A.72 kobka / cell	2,96m <sup>2</sup>
K.A.36 kobka / cell	1,75m <sup>2</sup>	K.A.77 kobka / cell	2,02m <sup>2</sup>
K.A.37 kobka / cell	3,40m <sup>2</sup>	K.A.78 kobka / cell	2,02m <sup>2</sup>
K.A.39 kobka / cell	5,83m <sup>2</sup>	K.A.79 kobka / cell	2,02m <sup>2</sup>
K.A.40 kobka / cell	2,68m <sup>2</sup>		



-  miesta, v ktorých sú vedené rozvody technickej infraštruktúry pod podchodnou výškou 2100mm
-  miesta, v ktorých sú vedené rozvody technickej infraštruktúry nad podchodnou výškou 2100mm



0 5 10 15

M 1:300

Upozornenie: Plochy jednotlivých miestností sú len orientačné. Vyobrazené zariadenie v pôdorysoch bytov (nábytok, kuch. linka, el. spotrebiče atď.) nie sú súčasťou dodávky. Rozsah dodávky je špecifikovaný v štandarde. Investor si vyhradzuje právo na drobné úpravy. Do kobiek môžu nad úroveň podchodnej výšky zasahovať rozvody technickej infraštruktúry. Investor si vyhradzuje právomoc trasať technickej infraštruktúry.

Note: This drawing is for illustration only. The set up of interior (furniture, kitchen, el. appliance, etc.) featured in the apartment drawings is not subject of delivery. The scope of delivery is specified in the standard. The investor reserves the right to implement minor changes. Above the minimum headroom of the cellars, the technical infrastructure distribution can interfere. The investor reserves the right to the technical infrastructure changes.